

- Verklaring dwarsprofielen:**
- Ontgraven zand
 - Aanvullen zand
 - Ontgraven/aanvullen zand
 - Zand, bestand
 - Drainkoffer, 300x300mm

- Opbouw bouwweg asfalt**
Schaal 1:20
- 2 lagen asfalt: AC 22 base dik 40mm
 - Menggranulaat 0/315, dik 250mm
 - Zand, bestand

- Opbouw bouwweg menggranulaat**
Schaal 1:20
- Menggranulaat 0/315, dik 250mm
 - Zand, bestand

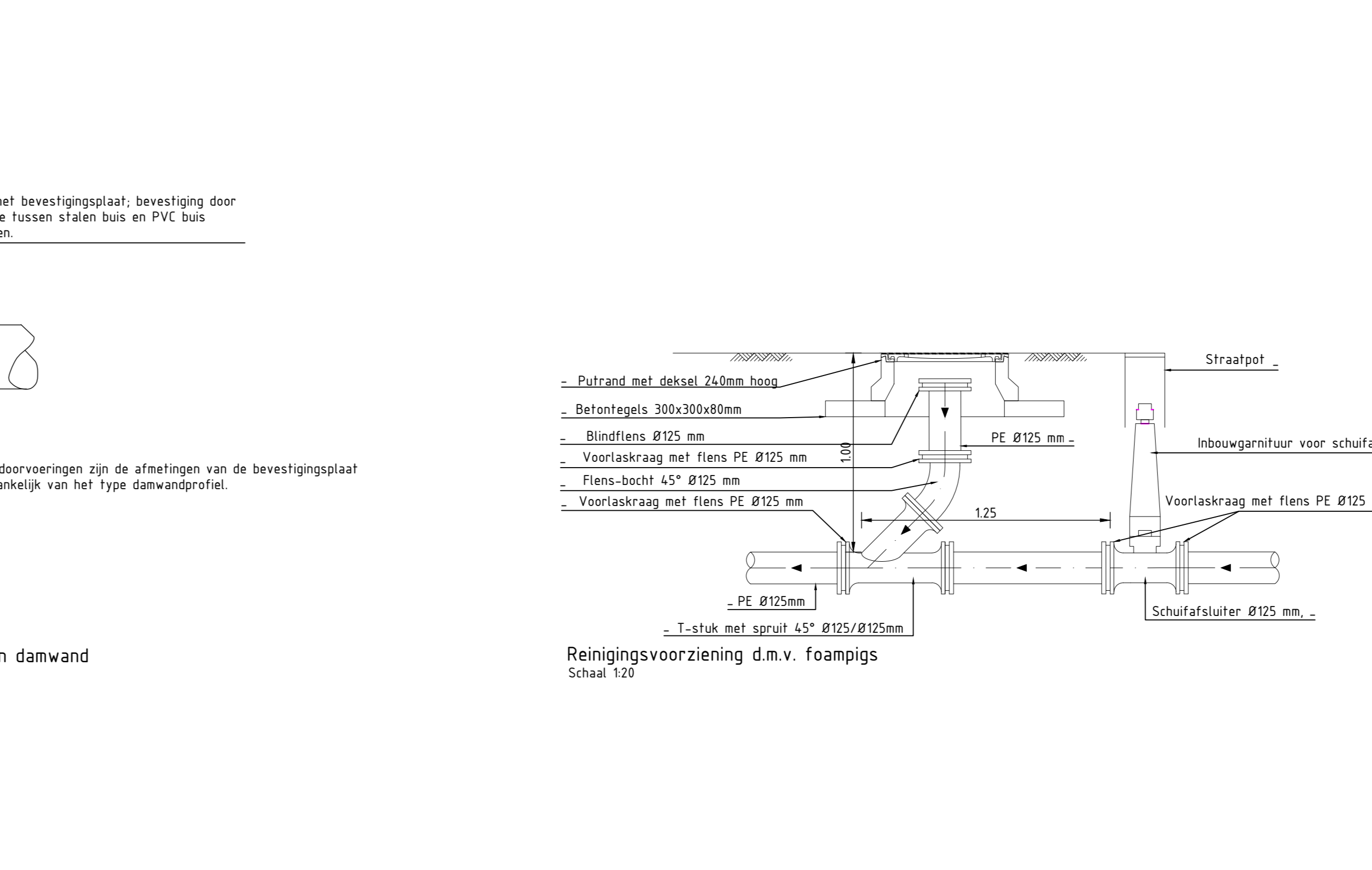
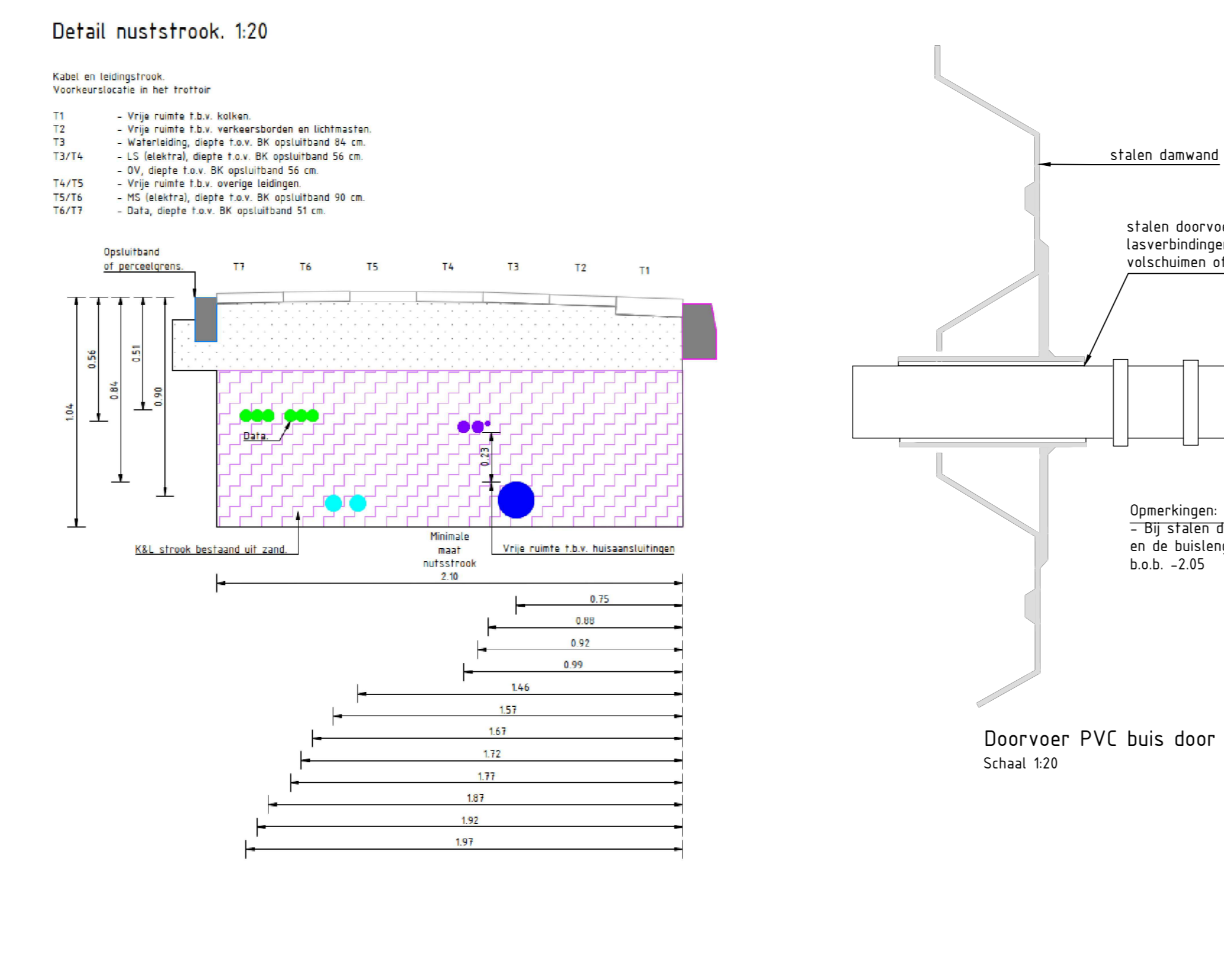
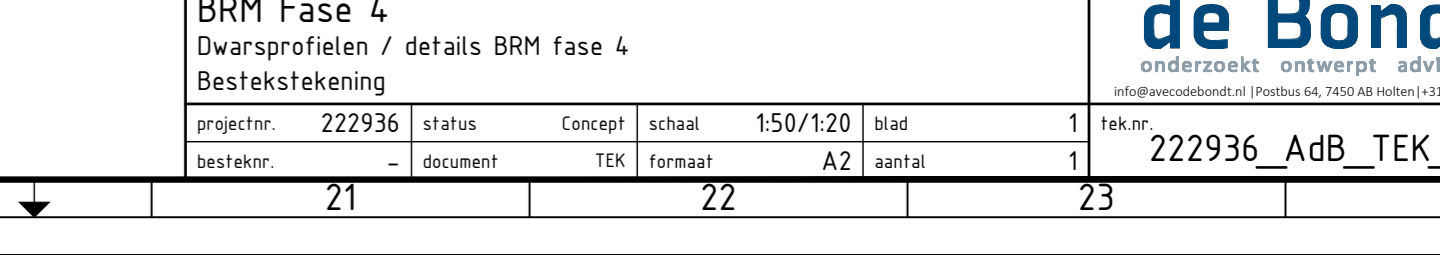
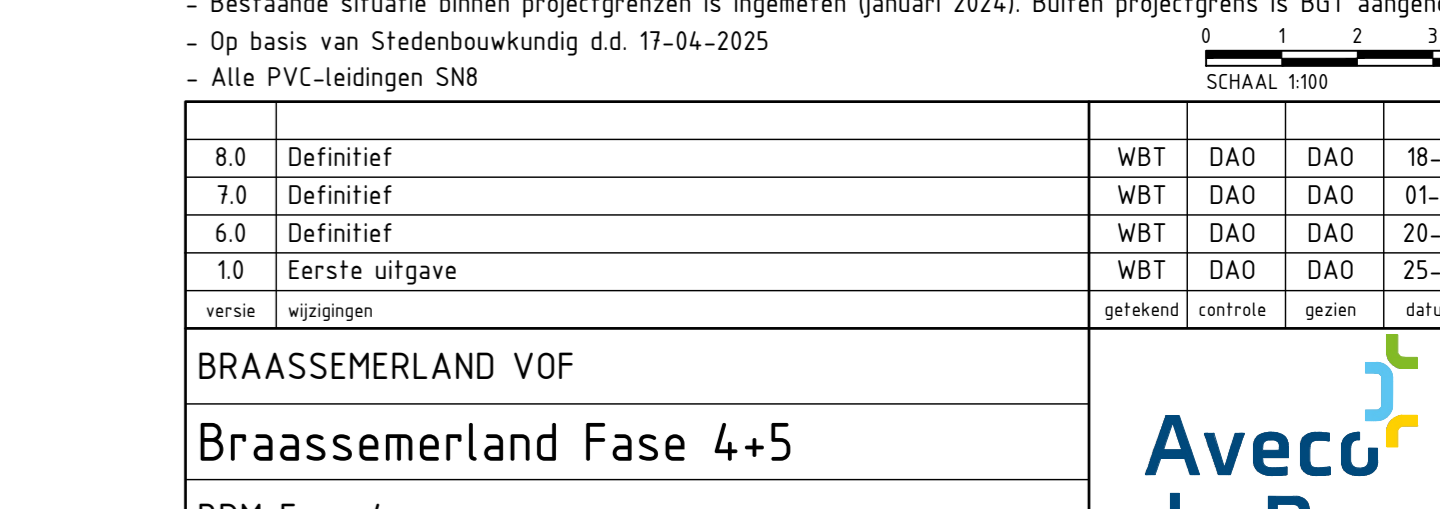
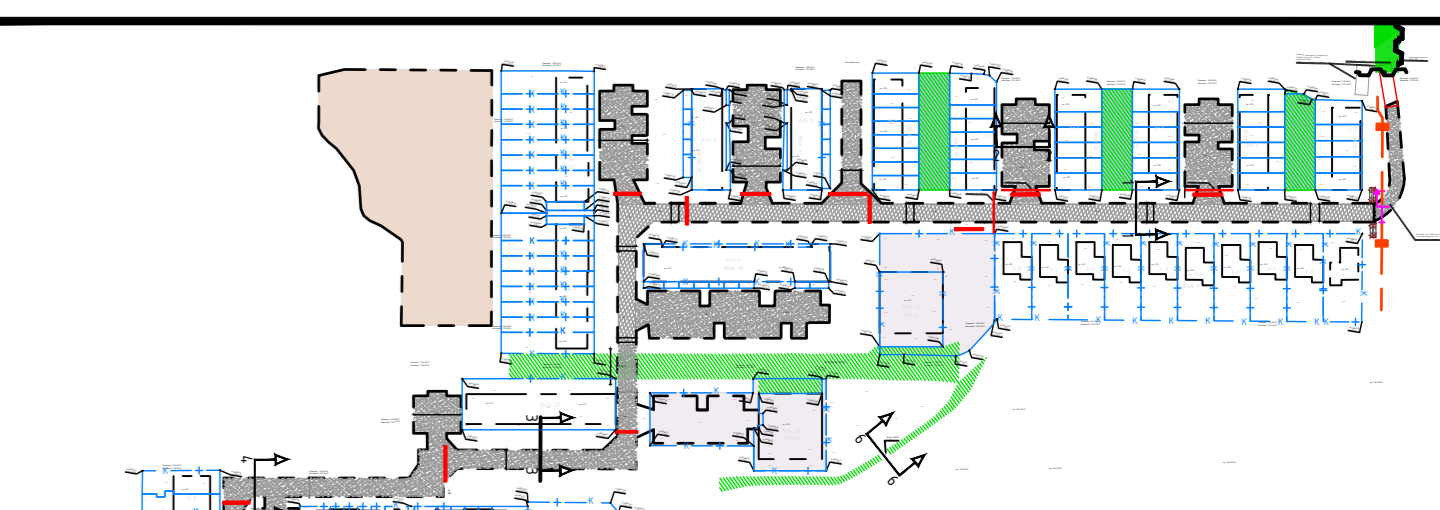
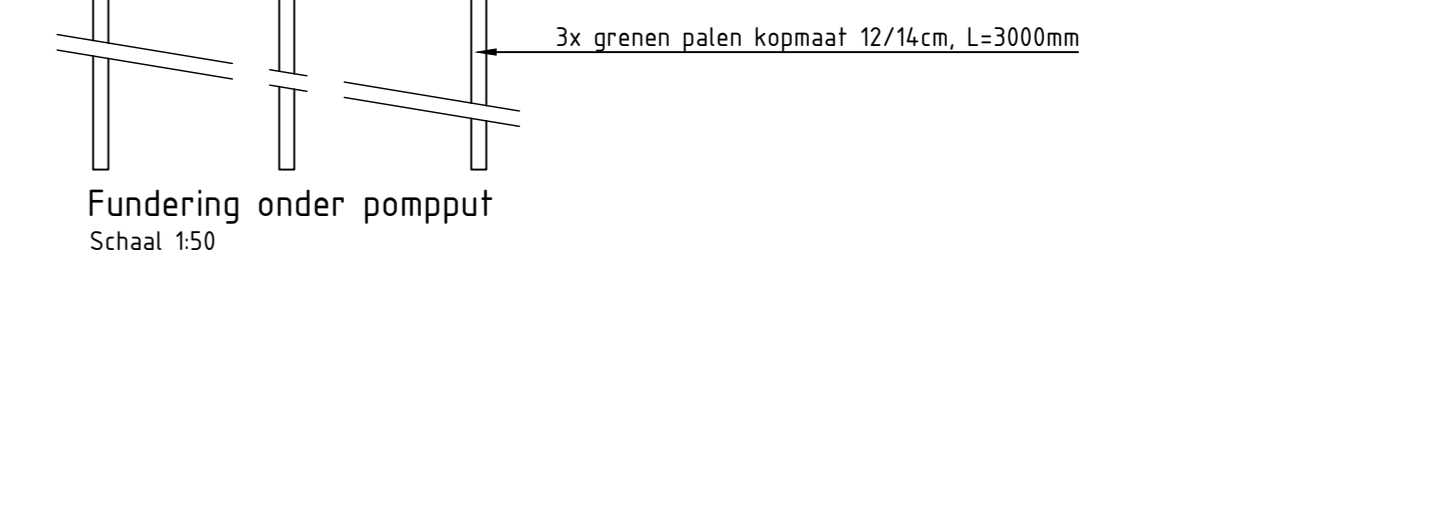
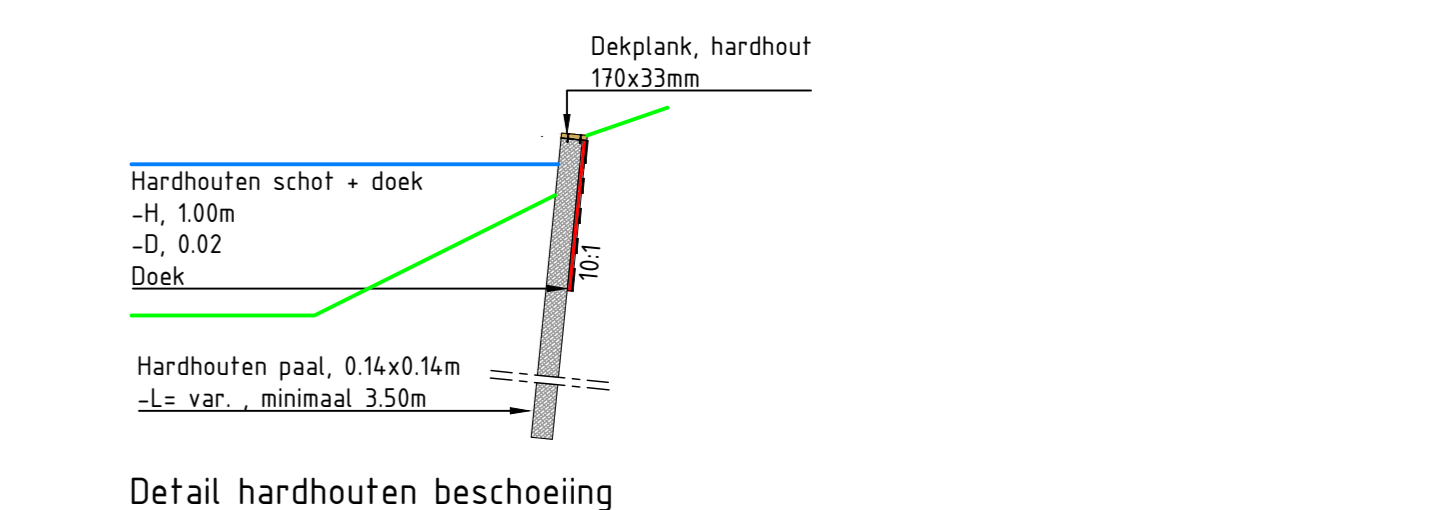
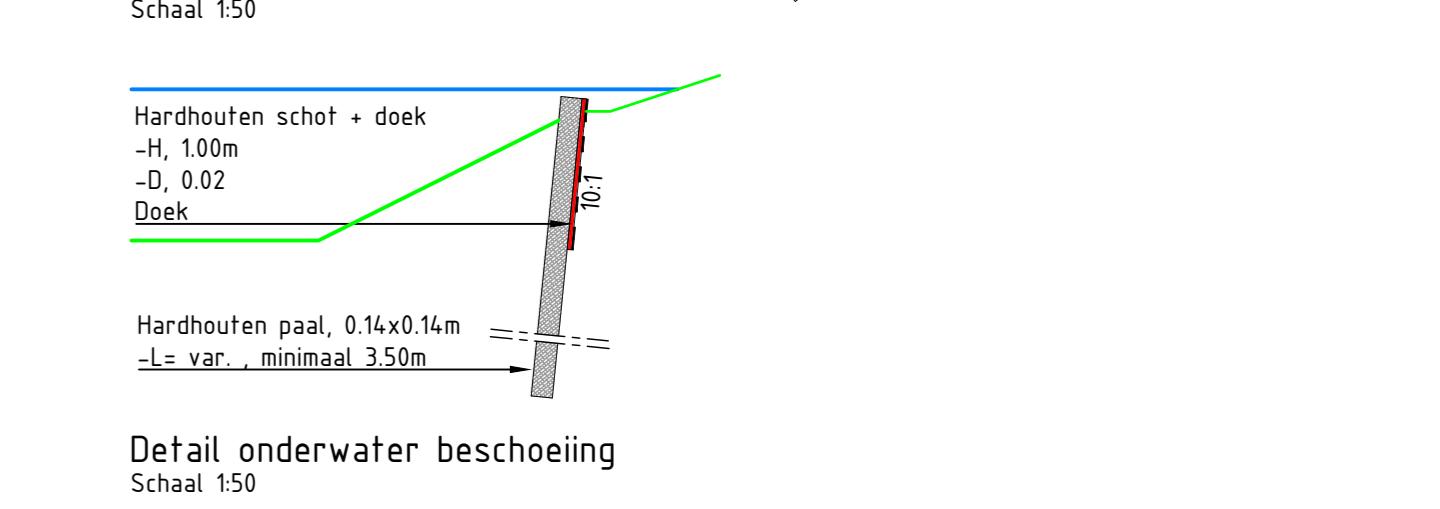
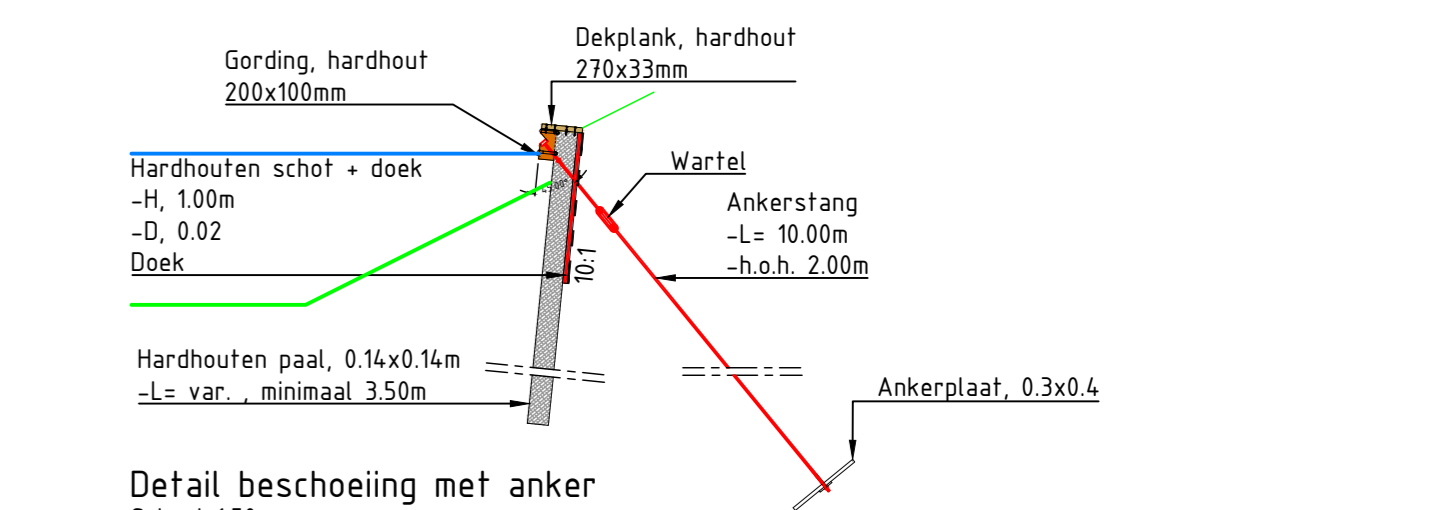
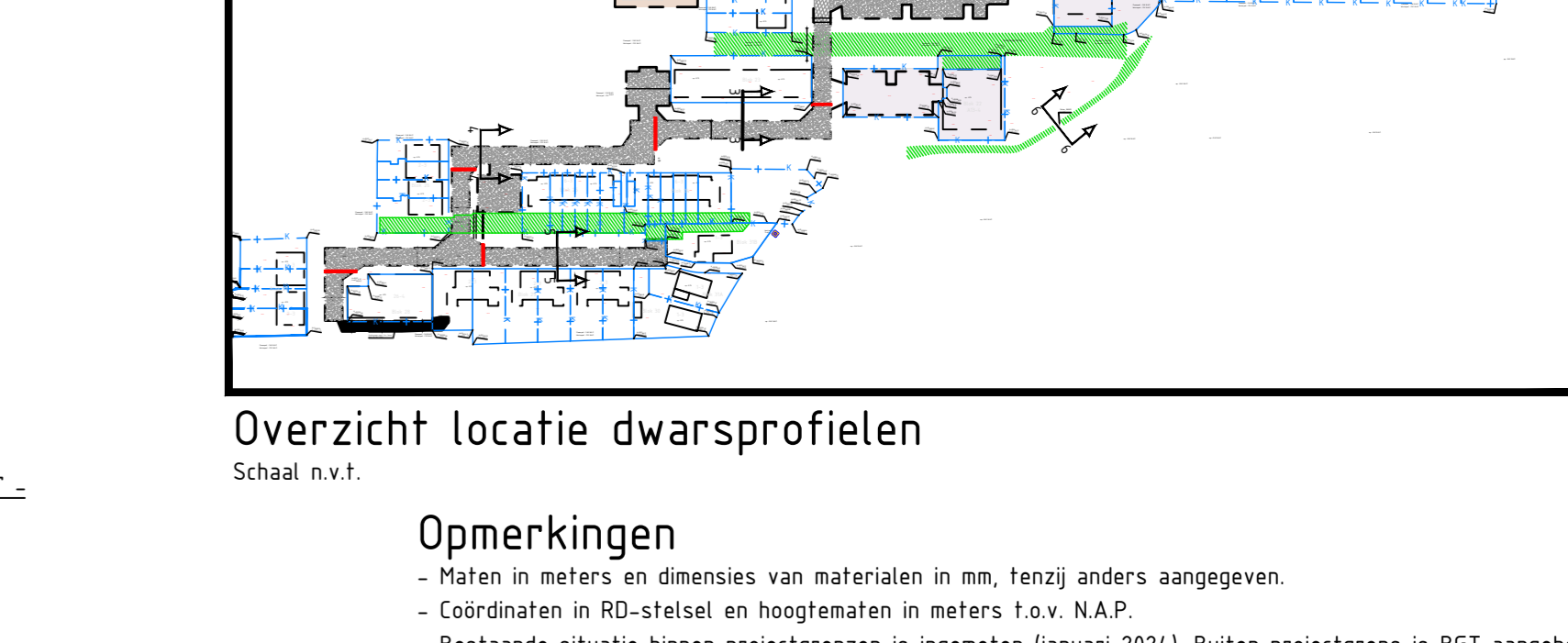
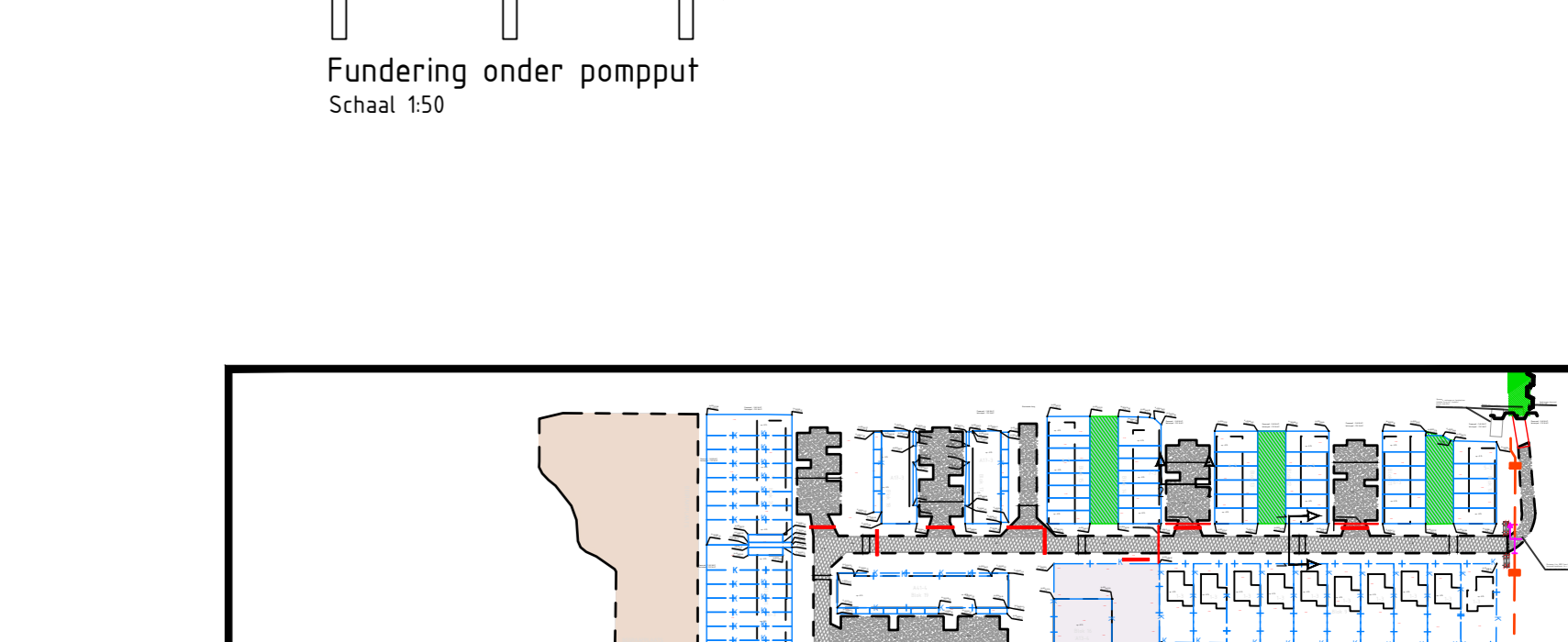
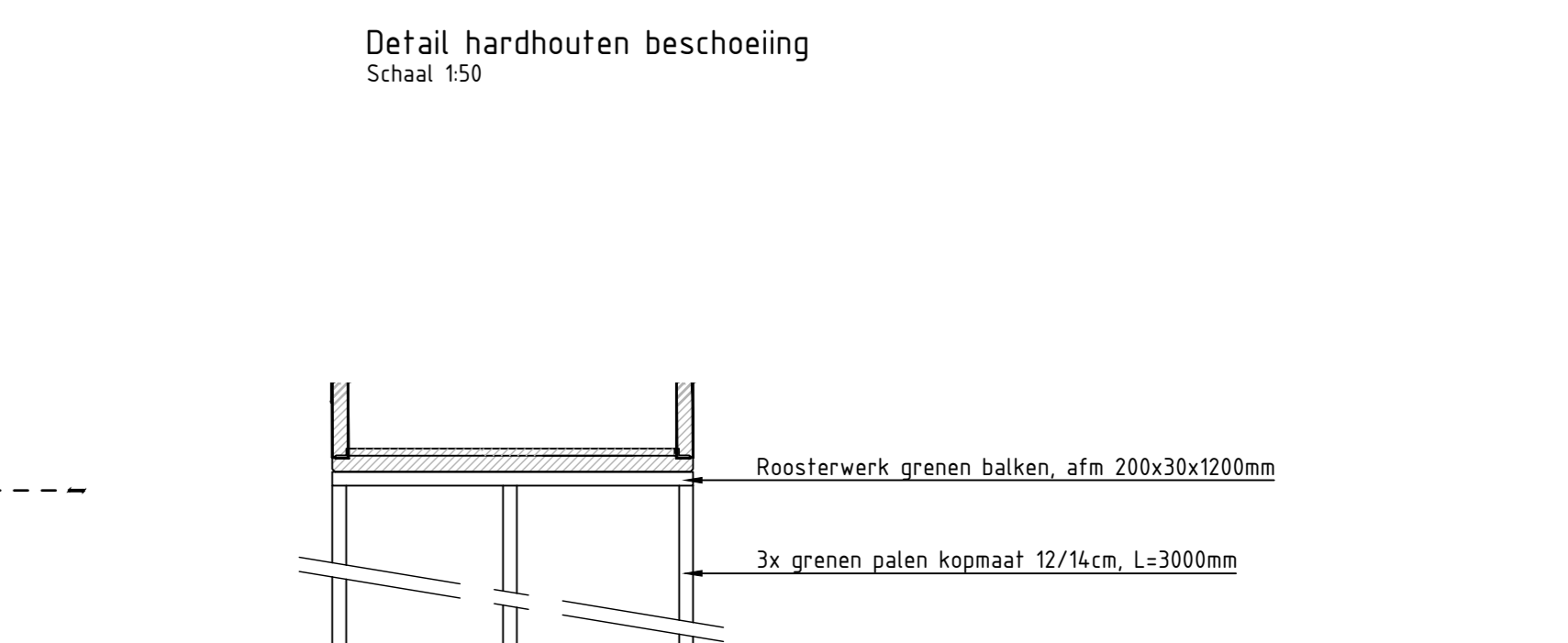
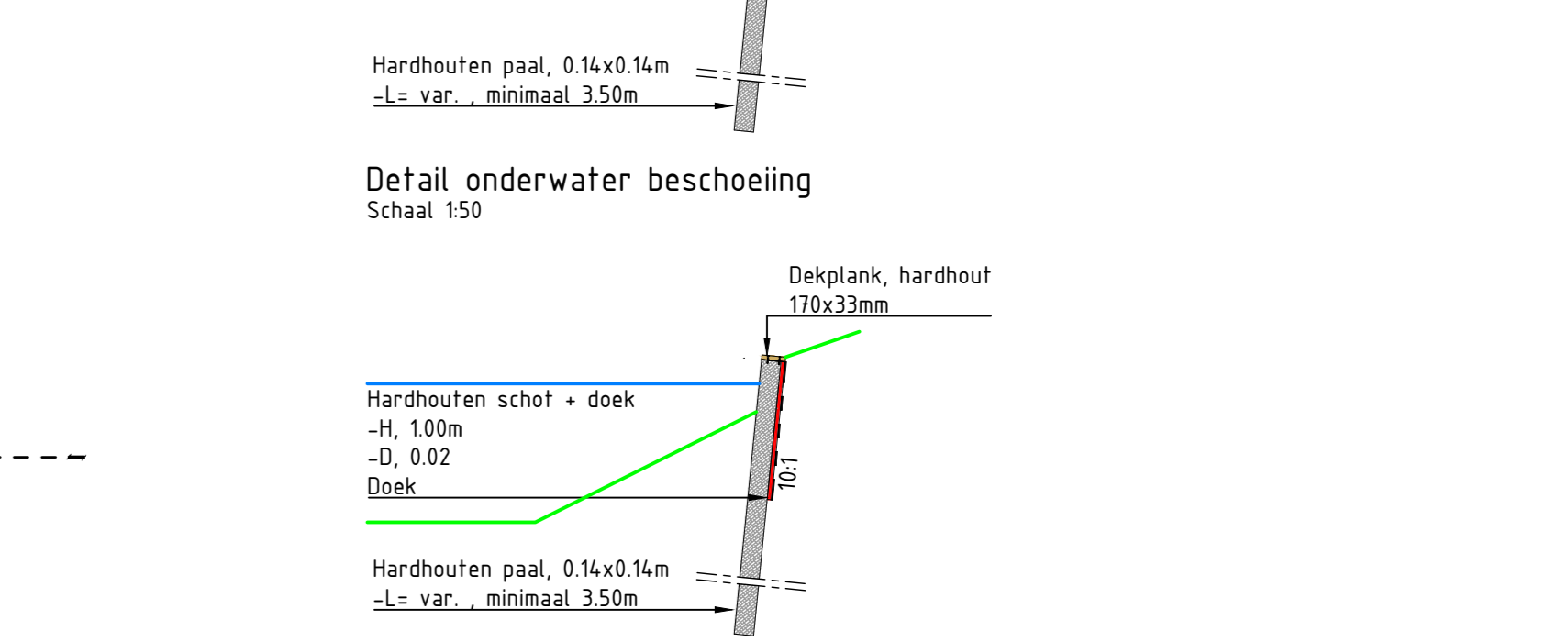
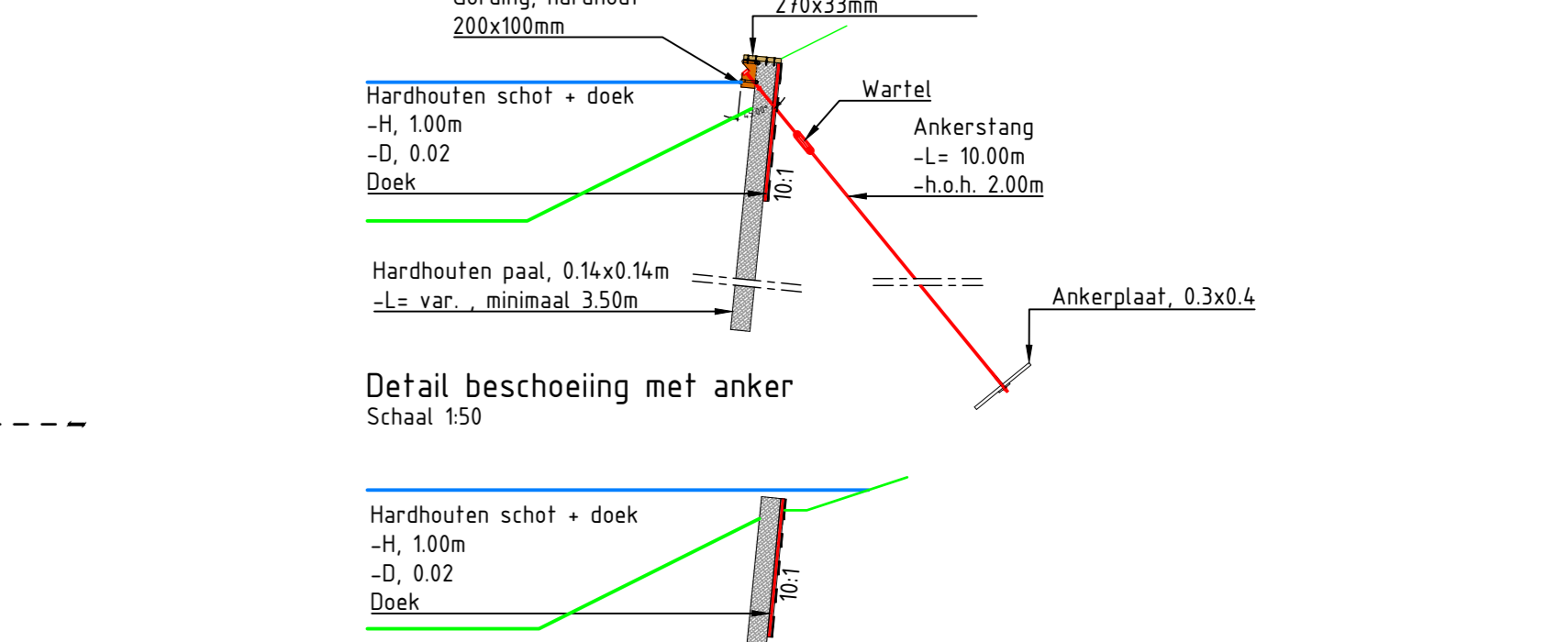
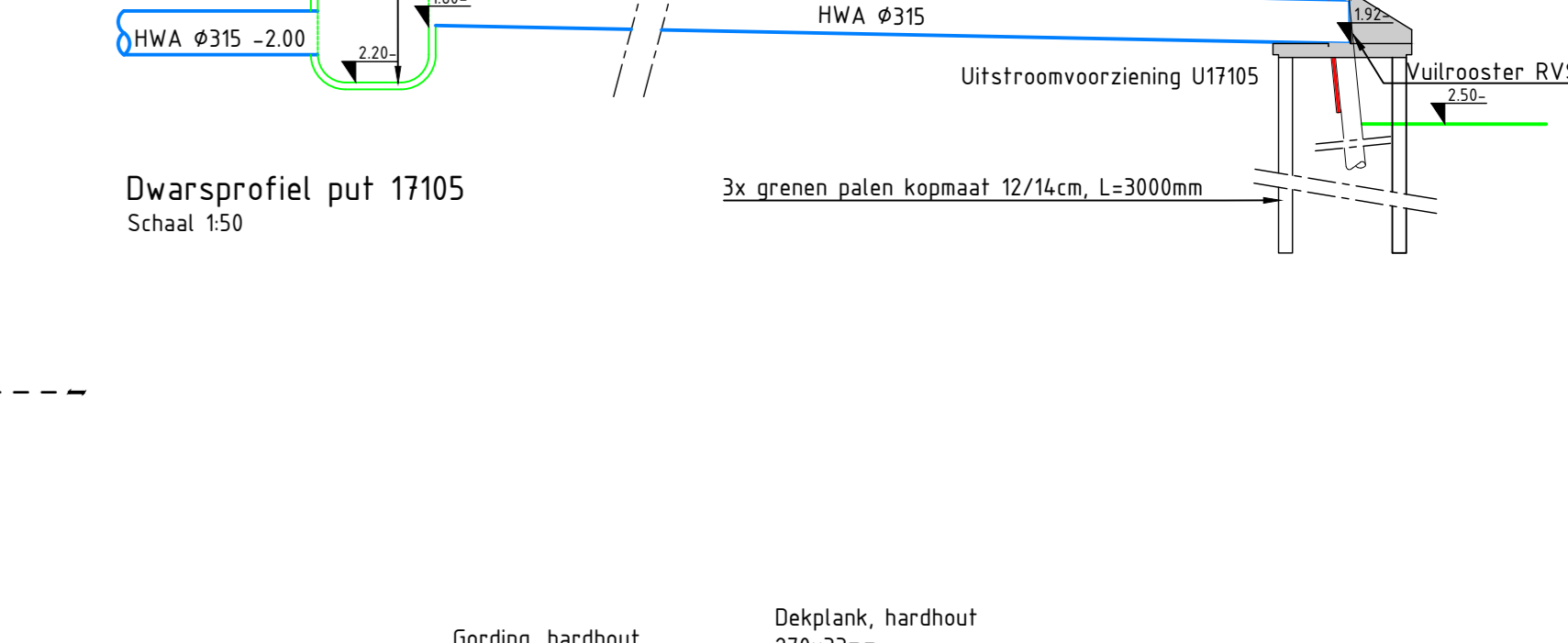
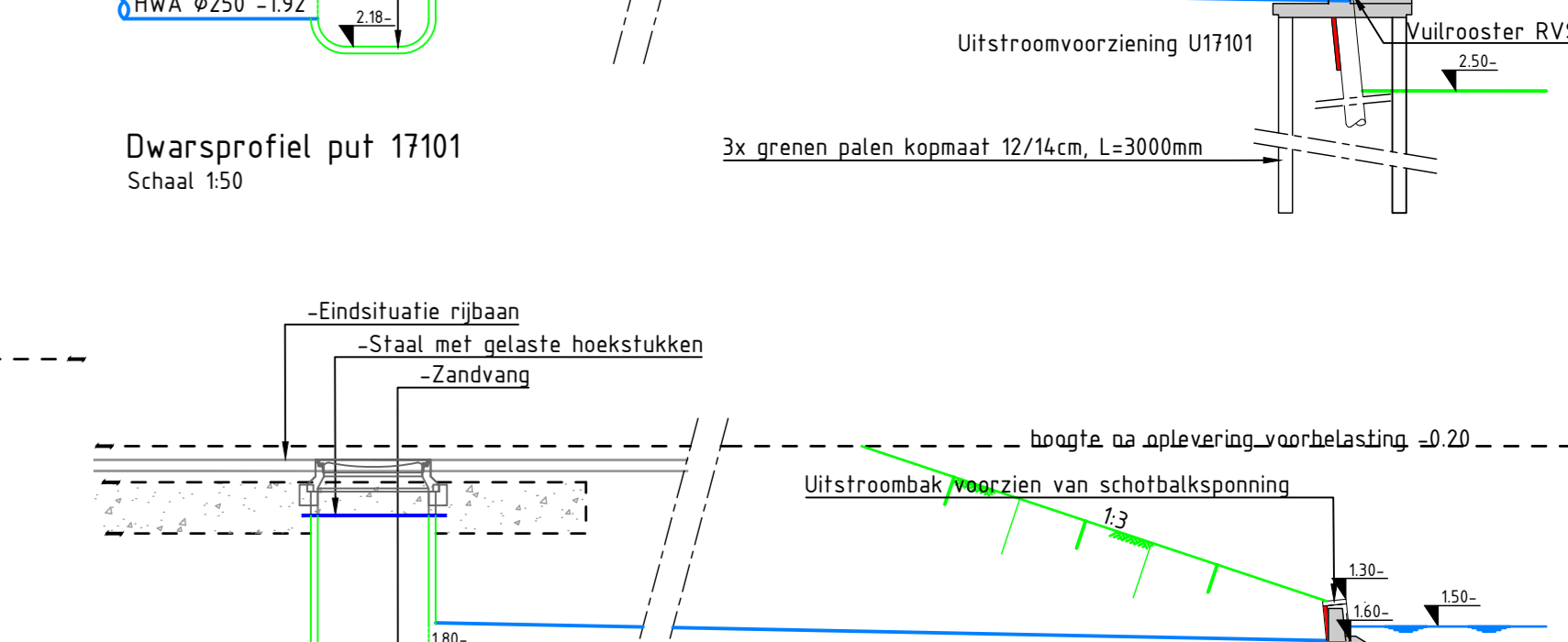
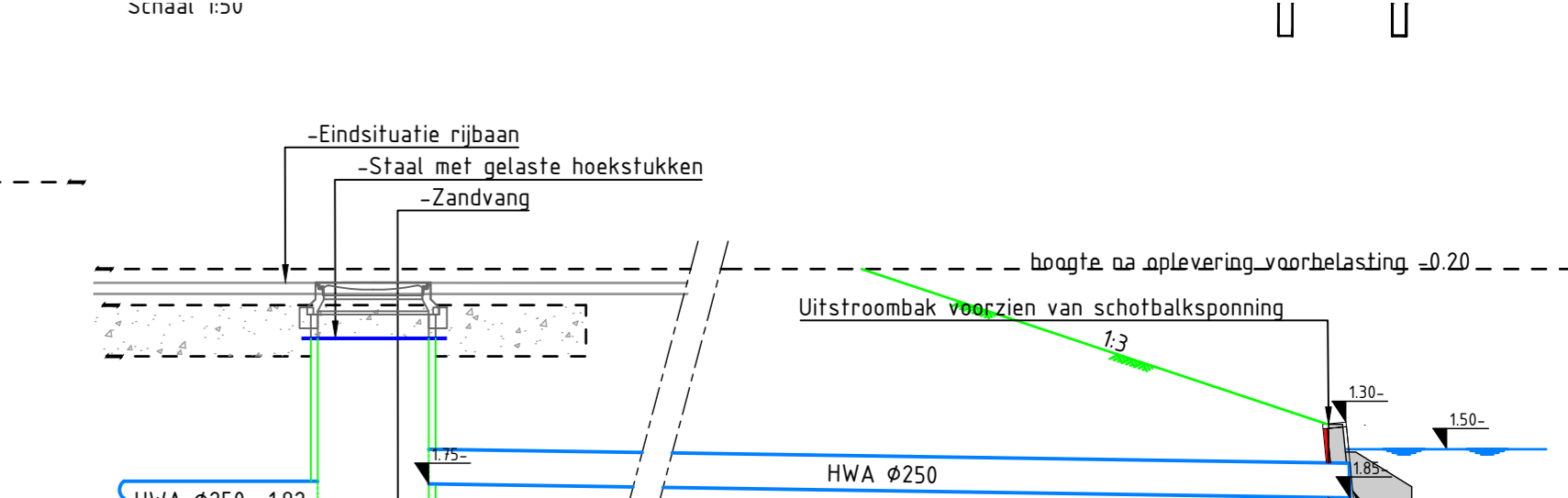
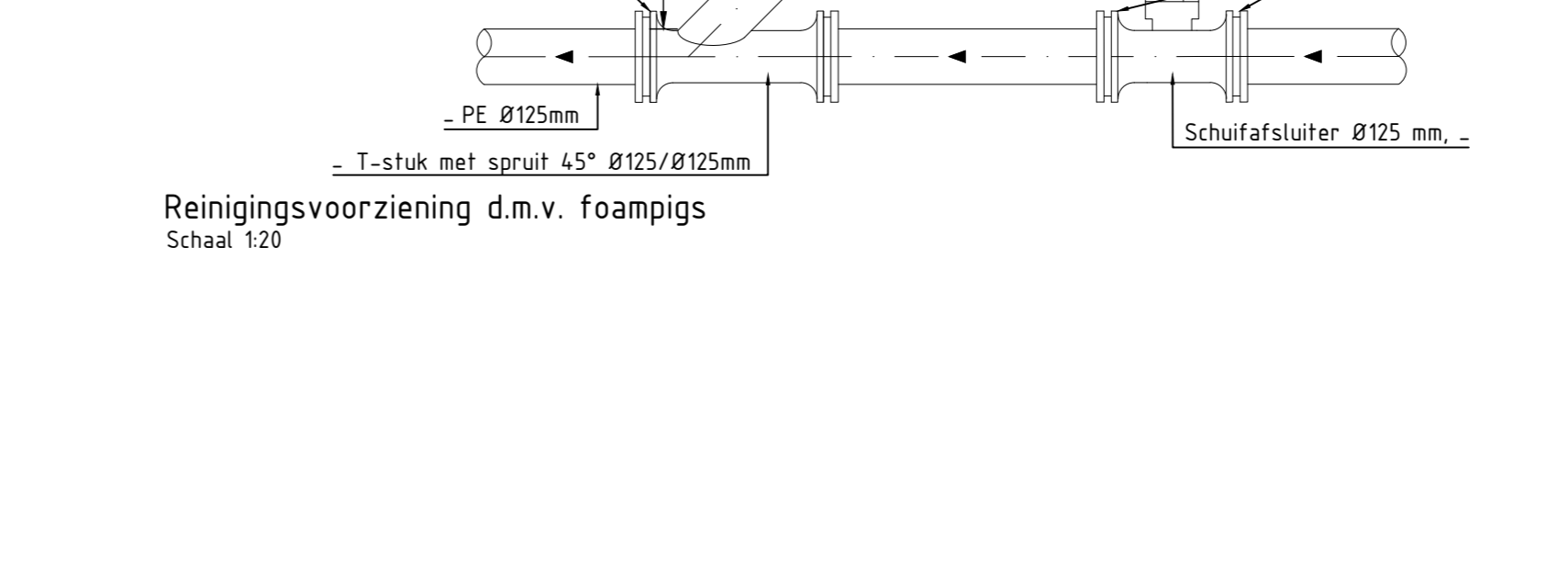
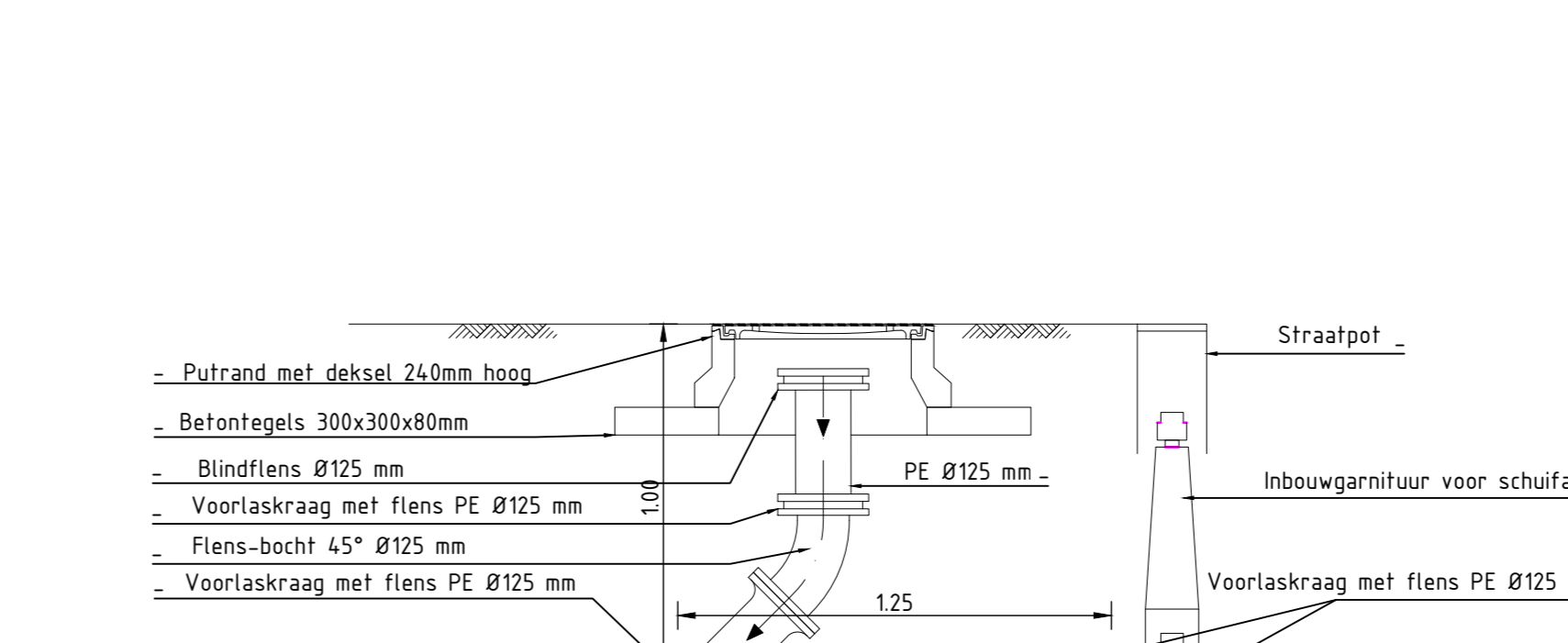
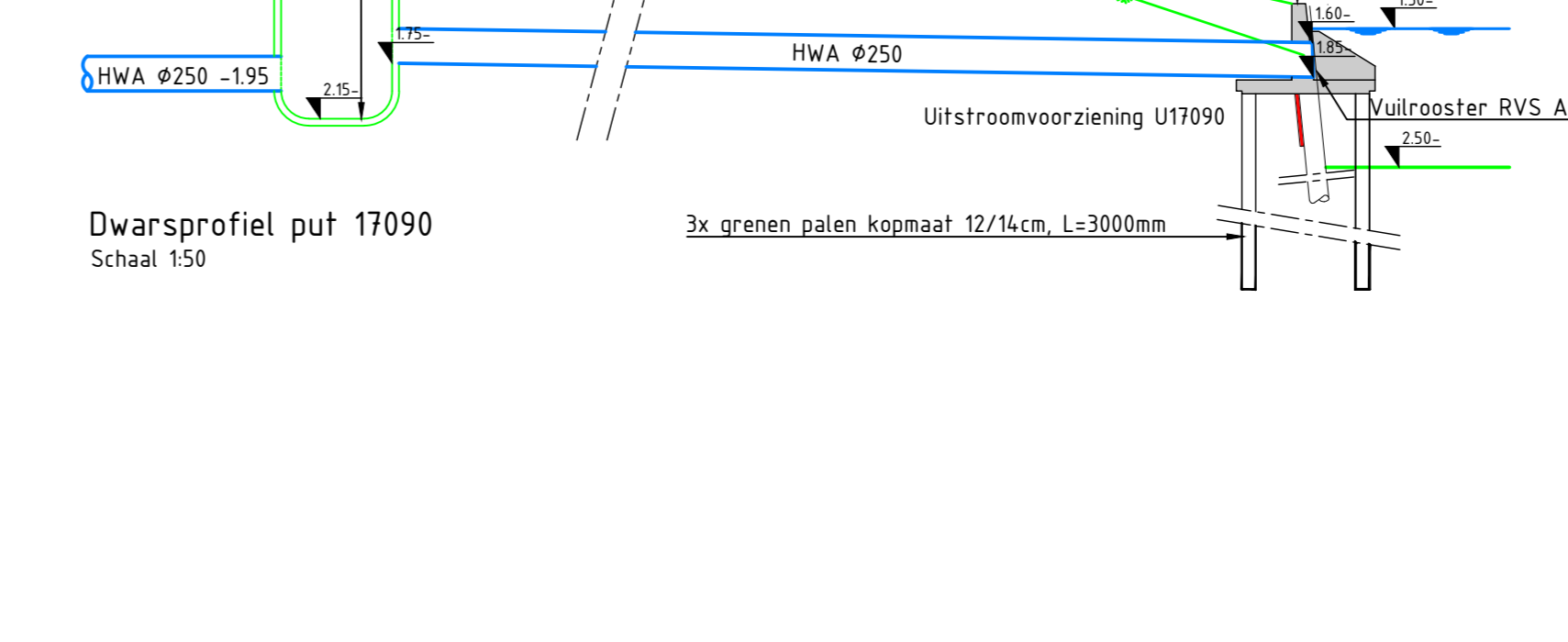
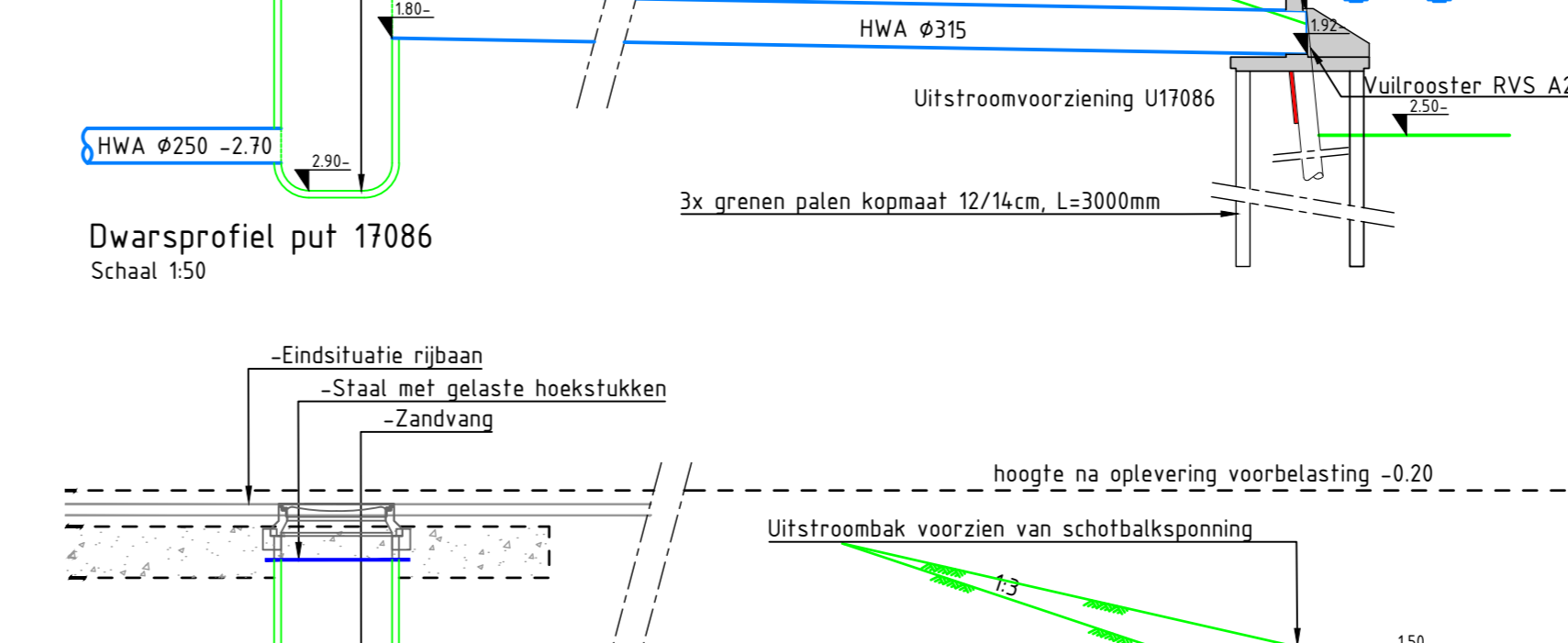
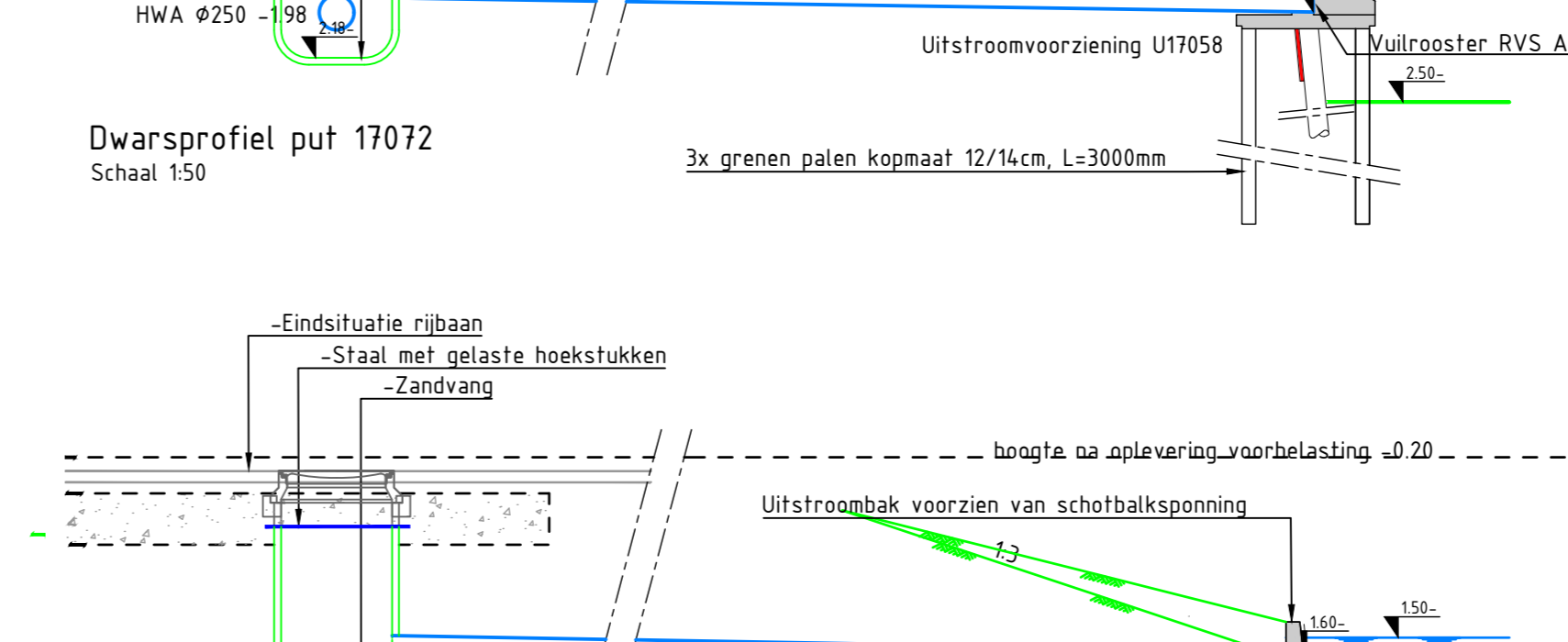
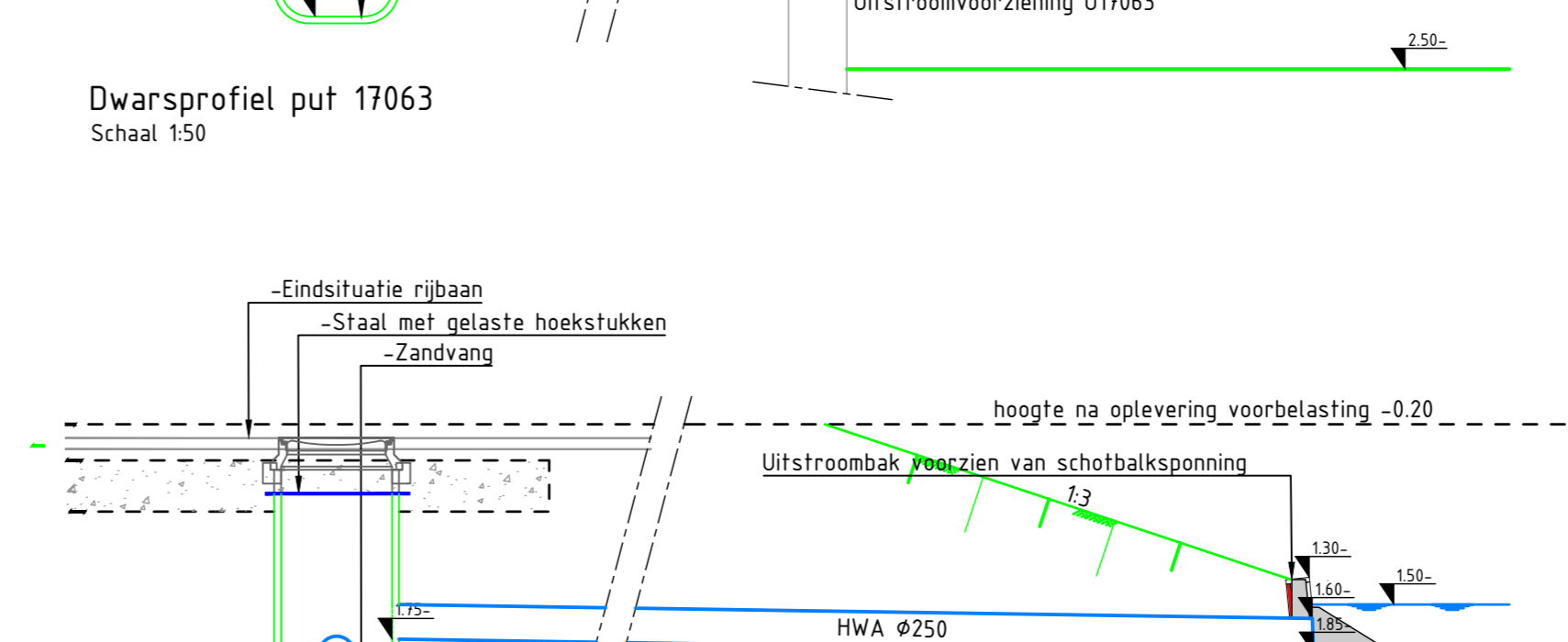
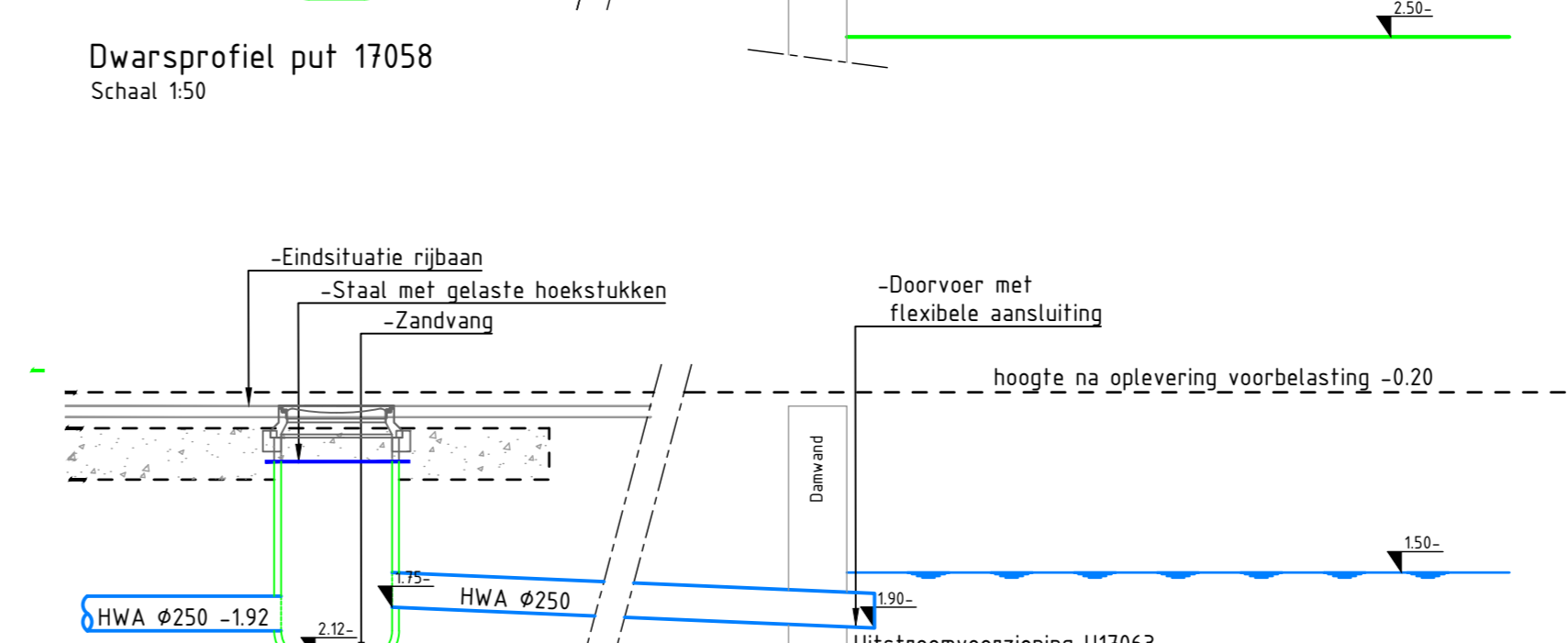
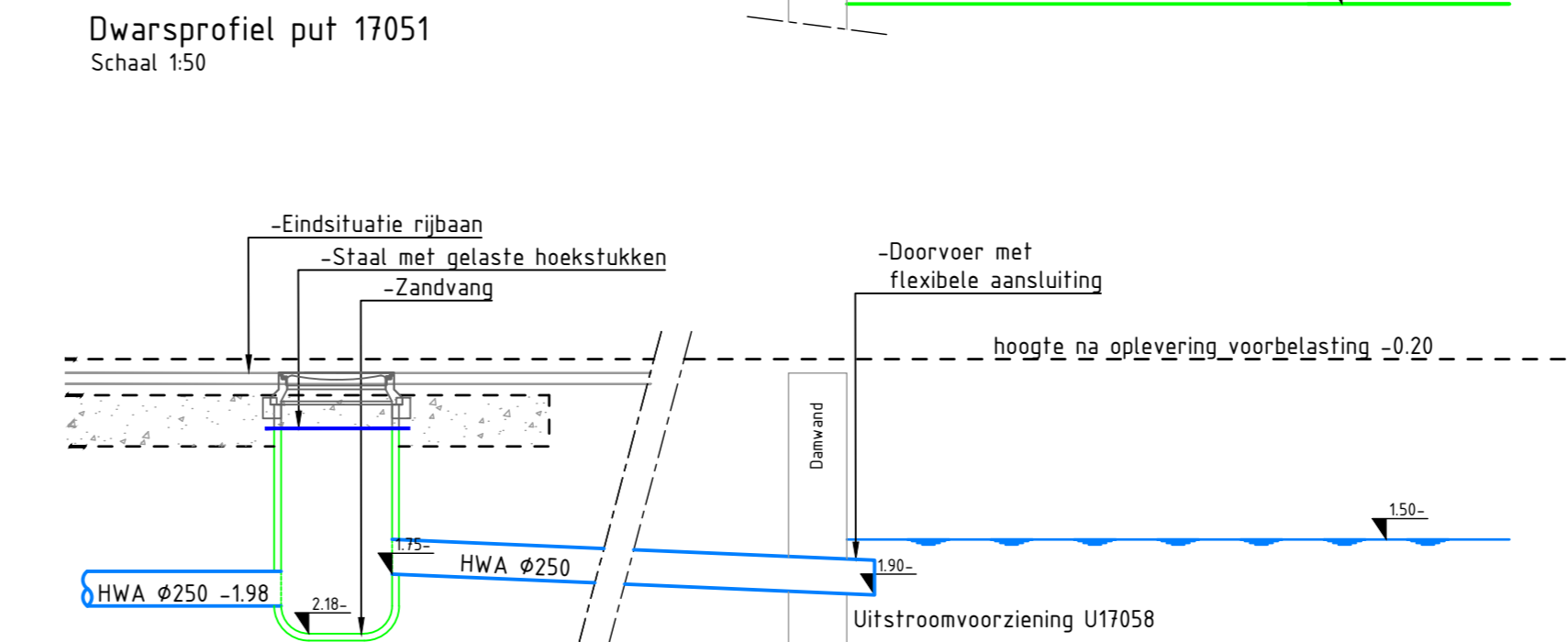
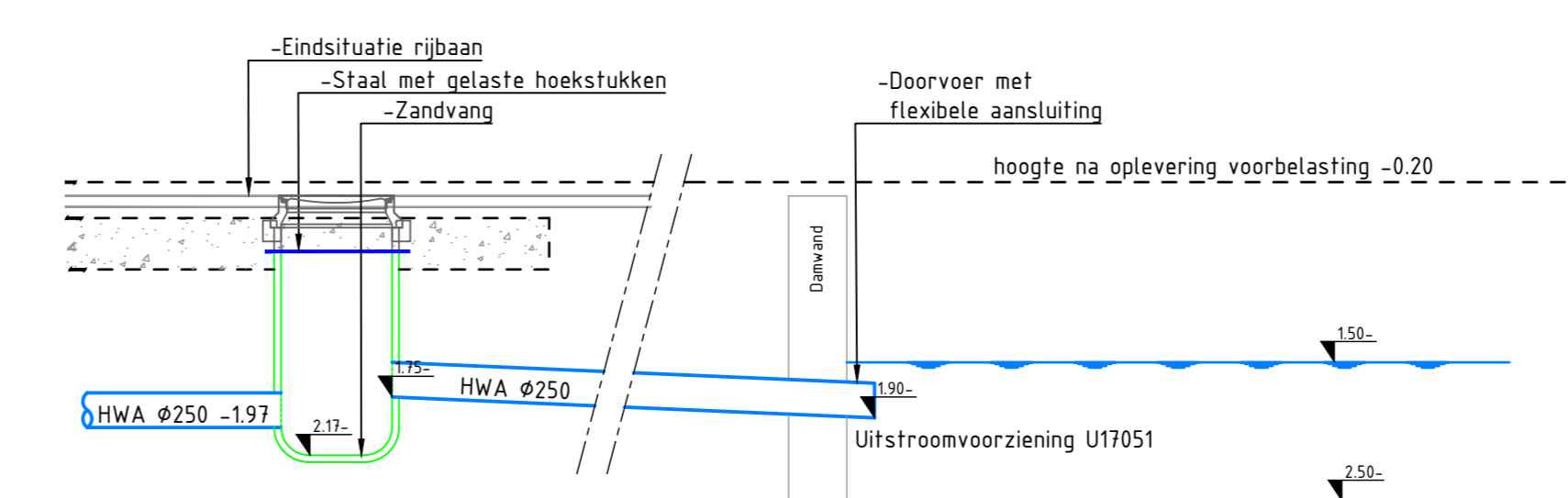
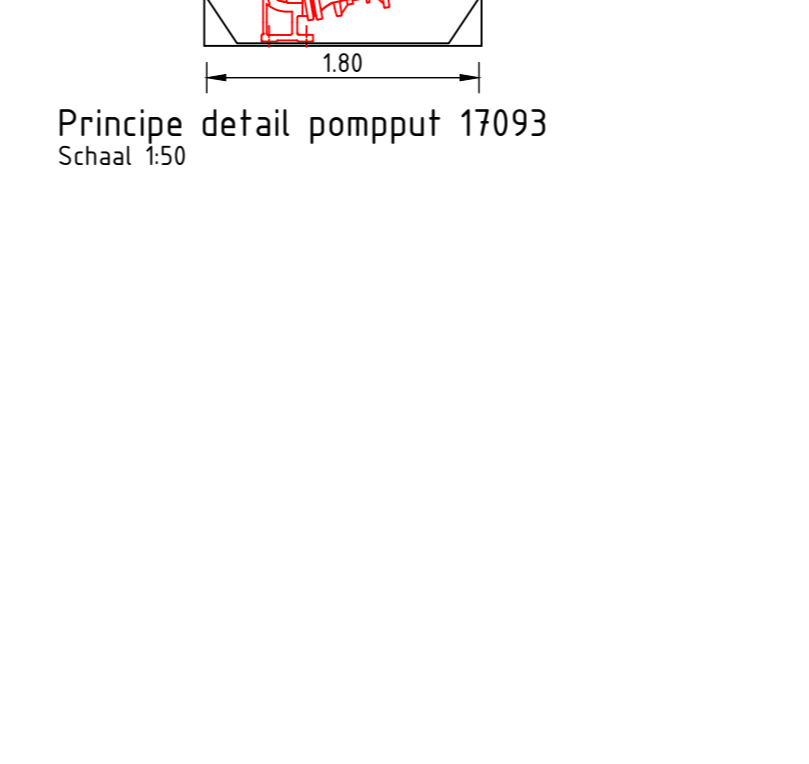
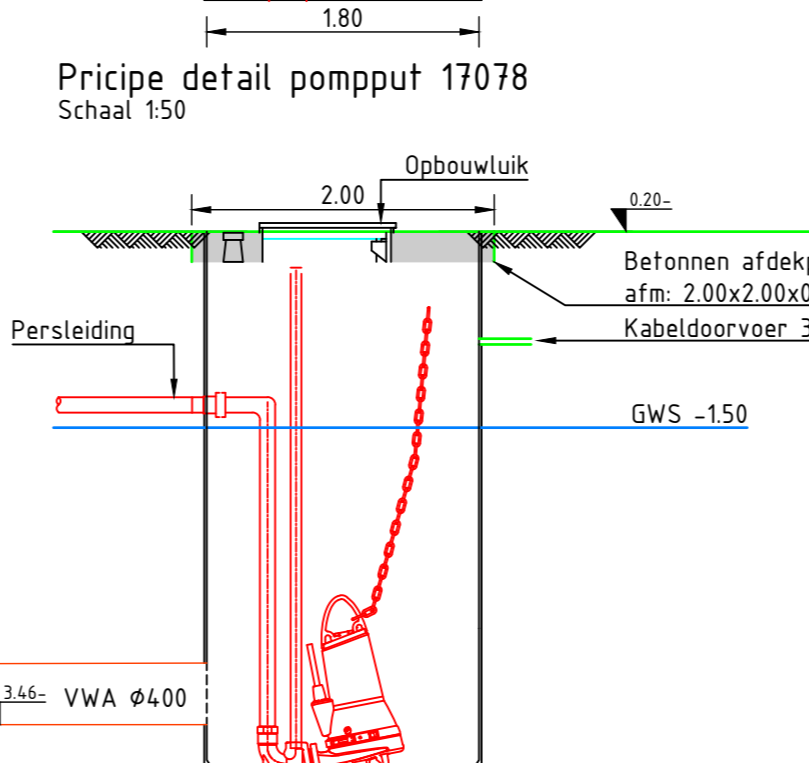
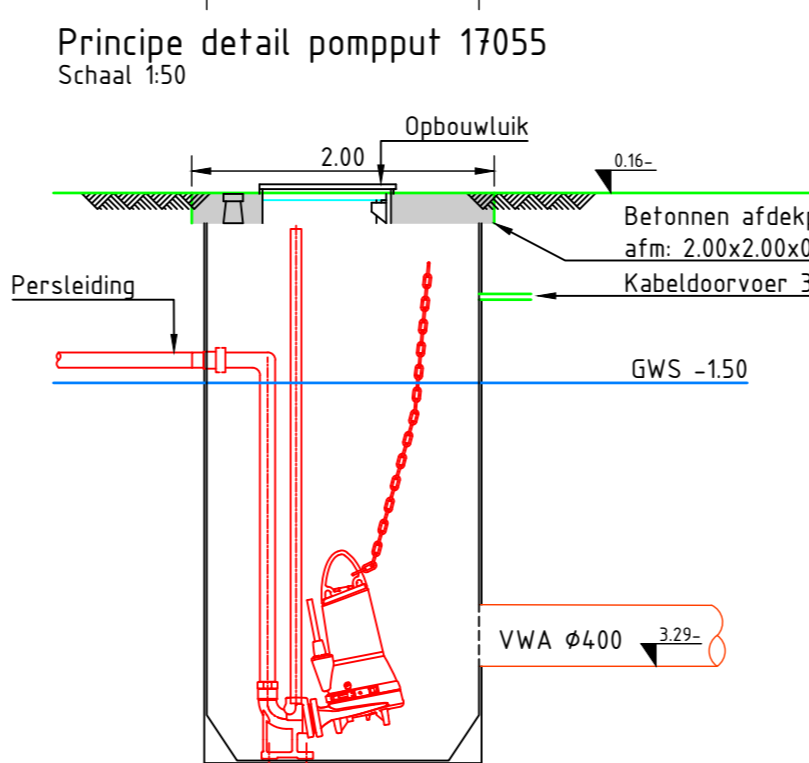
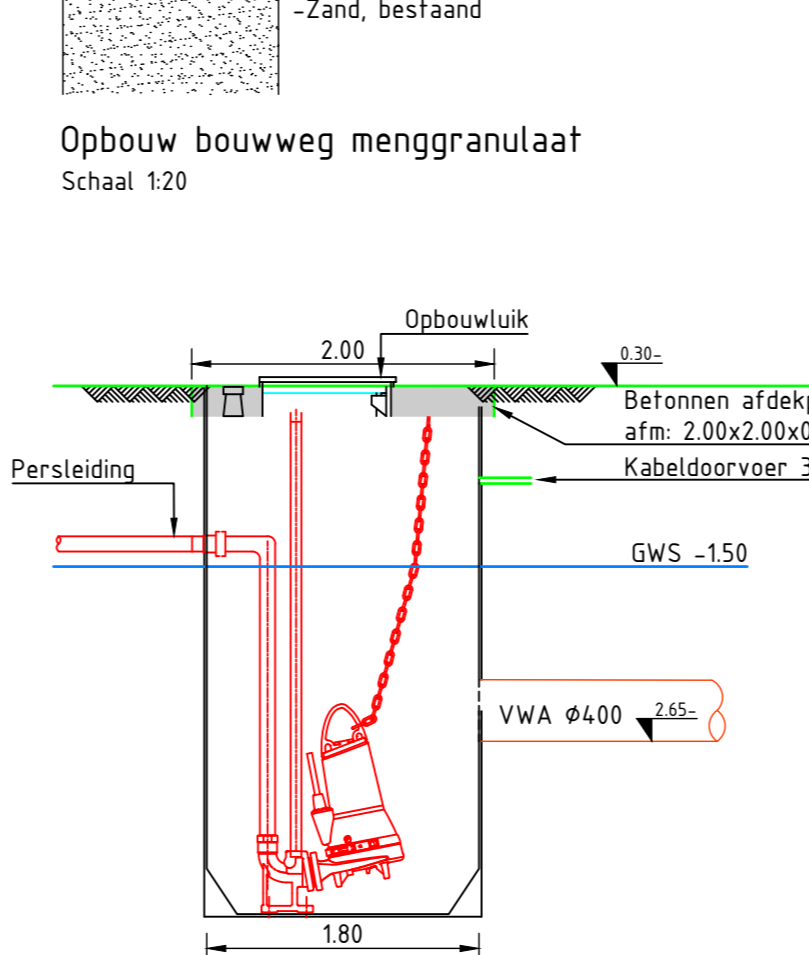

Overzicht locatie dwarsprofielen
Schaal n.v.t.

Opmerkingen

- Maten in meters en dimensies van materialen in mm, tenzij anders aangegeven.
- Coördinaten in RD-stelsel en hoogtematen in meters t.o.v. N.A.P.
- Bestaande situatie binnen projectgrenzen is ingetekend (januari 2024). Buiten projectgrens is BGT aangehouden.
- Op basis van Stedenbouwkundig d.d. 17-04-2025
- Alle PVC-leidingen SNB

Definitief	WBT	DAO	DAO	18-05-2025
8.0	Definitief	WBT	DAO	01-04-2025
9.0	Definitief	WBT	DAO	20-03-2025
10	Eerste uitgave	WBT	DAO	25-07-2025
versie	wijzigingen	getoetst	controle	geen

BRAASSEMERLAND VOF
Braassemerland Fase 4+5
BRM Fase 4
Dwarsprofielen / details BRM fase 4
Bestekstekening

projectnr	222936	status	concept	schaal	150/120	blad	1	nr	1
bestnr	1	blommet	100	A2	verl	1	1	222936	AdB_TEK_4034

Aveco de Bondt